

Email: safety.codes@cochrane.ca



The Alberta Safety Codes Act requires that a permit be obtained prior to beginning construction. Failure to obtain permits may result in the applicant being charged a double fee.

TOWN OF COCHRANE

Building Safety Codes

101 RancheHouse Rd.

Cochrane, AB T4C 2K8

Phone: 403-851-2572 Fax: 403-932-2935

Email: safety.codes@cochrane.ca



Fire Safety Plan

THIS PLAN MUST BE POSTED ONSITE AND OCCUPANTS/EMPLOYEES ARE EXPECTED TO
BE TRAINED IN HOW TO FOLLOW ITS PROVISIONS

Address:

Description of Project: **Deck**

Contact Personnel:

Phone #:

Specific Considerations:

- Fire extinguisher(s) will be available at all times during the progress of the construction
- Access to fire hydrants and buildings for fire apparatus must be maintained

Emergency Response Numbers: FIRE/POLICE/AMBULANCE: 9-1-1

General Considerations:

- A WARNING SYSTEM will be in place to warn of potential threats, and facilitate evacuation (yelling, ringing of a bell or horn, etc.)
- EVACUATE via the nearest exit if you are warned of a fire
- PROCEED to the main entrance (outside) and report to the Fire Department
- FIGHT the fire ONLY if it is small and you are NOT ALONE

Hazards Control:

- At the end of each day combustible refuse will be cleared from the site area and disposed of in bins or stored in neat piles. Unused construction material will be kept neat and orderly.
- No open-flame devices will be used inside buildings unless a dedicated watch is in place
- Liquid Propane Tanks or flammable liquids containers are not allowed within buildings

This Fire Safety Plan is designed in conformance with and is a requirement of Division B, Section 2.8.2 of the National Fire Code, and on signature, becomes an agreement between the building owner/contractor and the Town of Cochrane Fire department.

I have read and understand the above

Building Owner/Contractor Name:

Date:

DECK DESIGN FORM

HOUSE

Site Plan:

Deck size: ft X ft = ft²

Deck height: ft

Distance to Property Lines:

Rear: ft

Left side: ft

Right side: ft

Front(if applicable): ft

Stairs: Y or No

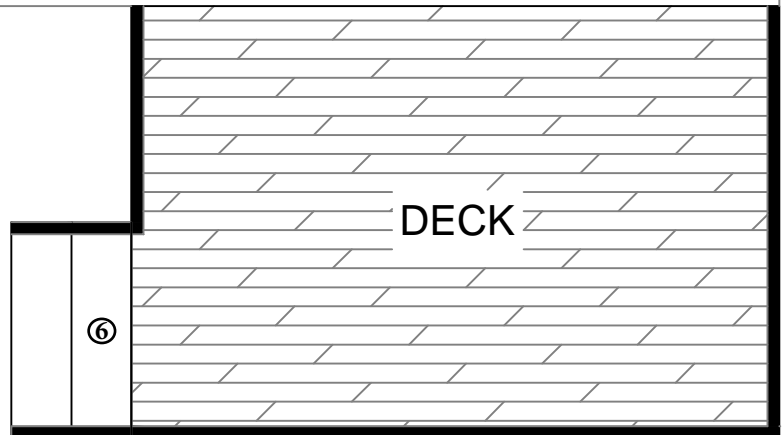

Construction Details:

① Joist size:(select one)

2X6 or

2X8 or

2X10 or

2X12

② Joist spacing:(select one)

12" on centre or

16" on centre or

24" on centre

③ Beam Size(min 3 PLY):(select one)

2X8 or

2X10 or

2X12

④ Post(min 6x6) spacing: ft

⑤ Foundation type:(select one)

*Pile:

Screw Pile([attach engineering](#)):

⑥ Stair(when applicable):

Min step run: 255mm(10.2")

Max step rise: 200mm(8")

Min stair width: 860mm(34.4")

⑦ Hand/Guardrail

⑧ Joist Overhang:

Max 18" for 2X6/2X8 Joists

Max 24" for 2X10/2X12 Joists

Span Table (Span Book 2009, Canadian Wood Council)
spans based on S-P-F No.1&2

JOIST SIZE	SPAN @ 12" O/C	SPAN @ 16" O/C	SPAN @ 24" O/C
2X6	10'-3"	9'-4"	8'-2"
2X8	12'-4"	11'-7"	10'-9"
2X10	14'-6"	13'-8"	12'-11"
2X12	16'-7"	15'-7"	14'-8"
BEAM(3PLY)	POST SPACING		
2X8	10'		
2X10	12'-10"		
2X12	14'-11"		

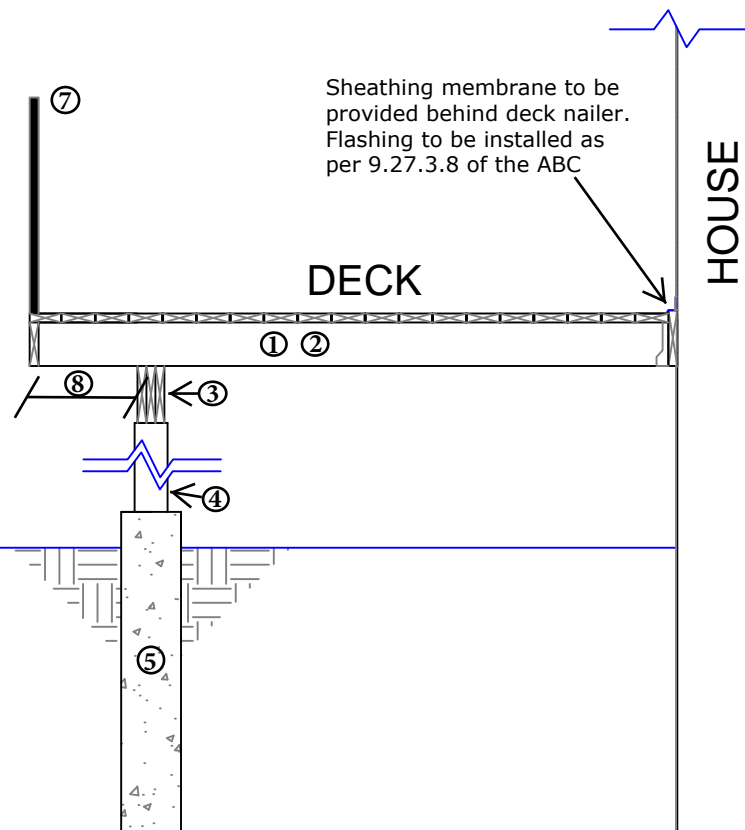

Foundation Notes:

Concrete piles (min 9" in diameter) are to be installed not less than the depth of frost penetration and extend 150mm(6") above grade.

Town of Cochrane

Planning & Engineering Services

Safety Code Inspections

101 RancheHouse Road

Cochrane, AB T4C 2K8

Phone: 403-851-2572 Fax: 403-932-2935

Email: safety.codes@cochrane.ca



REQUIREMENTS FOR RESIDENTIAL DECKS

General Information

Building Permit Requirements

1. Building Permit Application Form to be completed by owner.
2. Fire Safety Plan Form to be completed by owner.
3. Deck Design Form to be completed by owner or builder.

GENERAL REQUIREMENTS:

REQUIRED GUARDRAILS:

On each side of Stair Tread or Deck Floor not protected by a wall that is equal to or greater than 600 mm (2') above adjacent ground level or the adjacent surface within 1.2m(4') of the deck floor has a slope more than 1 in 2.

GUARDRAIL HEIGHTS:

Deck height of 600 mm (2') to 1.8m(5.9'), 900 mm(36") high guards required.

Deck height over 1.8 m(5.9'), 1070 mm(3.5') high guards required.

DESIGN OF GUARDS

Openings in Guards shall not exceed 100 mm(4").

REQUIRED HANDRAILS:

Stairs containing 3 risers or more require a handrail on at least one side

HANDRAIL HEIGHT:

Handrails on stairs shall not be less than 865 mm(34.6") and not more than 965 mm(38.6") high.

DESIGN OF HANDRAIL:

A handrail shall have a clearance of not less than 50 mm(2") from any surface behind it. Handrails shall be constructed so as to be continually graspable along the entire length.

FOR ALL STAIR, RAMP, HANDRAIL AND GUARD REQUIREMENTS, PLEASE REFER TO SECTION 9.8 OF THE NATIONAL BUILDING CODE (2019) AB EDITION.

Recommended Deck Ledger Attachment



Structural wood screws can be used to fasten deck ledgers to the rim board (AKA band / rim joist) of structures in residential constructions. The most common lengths for the deck ledger application are 3.5" and 5" long, respectively. Order screws with the "Exterior" suffix to ensure you are receiving screws with the Exterior Coat Finish.

Installation:

- Select the proper screw length. The threads should have full engagement with the rim board and the tip of the screw should be protruding and visible beyond the inside face of the rim board member.
- With appropriate screw length selected, drive the screw through the ledger, sheathing, and rim board joist with a high torque variable speed drill.
- Drive screw so head is firm and flush with surface of deck ledger, but do not overdrive.
- Repeat these steps and install the appropriate number of screws at the prescribed edge, end distances, and spacing as called out in Table 1 and Figure 1.

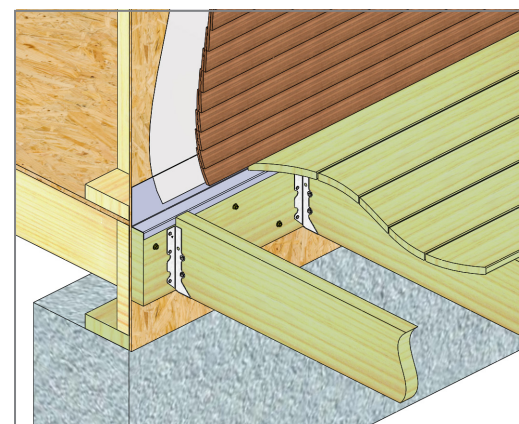

Attaching ledger to rim board

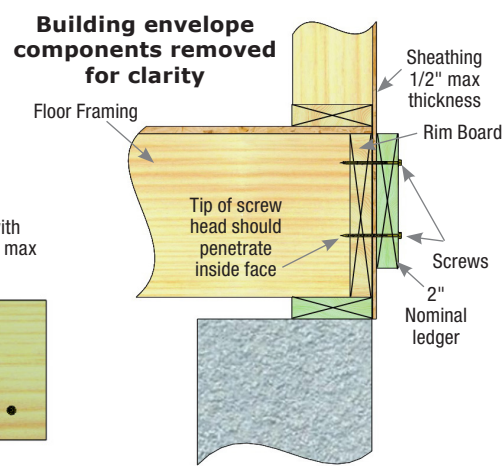

Section View

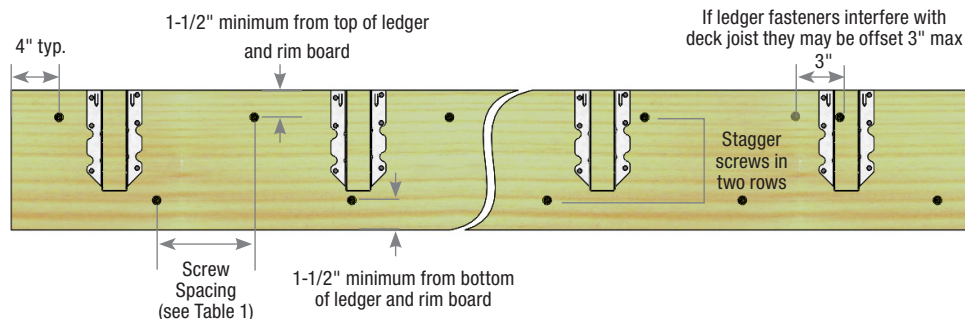

Figure 1

Table 1

Live Load	Ledger	Rim Board	Spacing between Screws based on Joist Span (in)						
			≤ 6-ft	≤ 8-ft	≤ 10-ft	≤ 12-ft	≤ 14-ft	≤ 16-ft	≤ 18-ft
40 psf/ 1.9 kPa	2x Solid Sawn	2x Solid Sawn	21	16	12	10	9	8	7
		1" Min EWP	23	17	14	11	10	8	7

- 1) For insulated rim boards, consult the rim board manufacturer for acceptable mounting details.
- 2) For ponywall connections, screws to penetrate directly into the ponywall studs