

TOWN OF COCHRANE

Building Safety Codes

101 RancheHouse Rd.
Cochrane, AB T4C 2K8
Phone: 403-851-2572 Fax: 403-932-2935
Email: safety.codes@cochrane.ca



Fields marked with an * are required

Homeowner Deck Application

OWNER INFORMATION

| | |
|---------------------|---|
| Owner Name* | Phone* |
| Mailing Address* | Email* |
| City & Postal Code* | Additional Information if required: Sq.Ft * |
| Project Address* | |
| | Estimated Construction Value* |
| | |

APPLICANT DECLARATION I certify that I am the owner/agent submitting this application and construction will be completed in accordance with the Alberta Safety Codes Act and Regulations and will commence within **90 days**. I understand homeowner permits are to be completed within **365 days**.

I have read and understand the applicant declaration *

Applicant Name(Print)

Application Date(mm,dd,yyyy)

Please see our website for additional information regarding Basement Developments

The personal information requested is collected under the Safety Codes Act, Section 63, The Municipal Government Act, Section 301.1, the Alberta Freedom of Information and Protection of Privacy Act (FOIP) Section 33(c) and will be protected under Part 2 of the FOIP Act. The information is used for issuing permits, safety codes compliance verifications, monitoring and property assessment purposes. Information collected by public bodies forms part of a file that may be available to the public. Please direct any questions about this collection to: FOIP Coordinator, 2nd Floor, 101 Ranchehouse Road, 403-932-2674 or FOIP@cochrane.ca.

The Alberta Safety Codes Act requires that a permit be obtained prior to beginning construction. Failure to obtain permits may result in the applicant being charged a double fee.

TOWN OF COCHRANE

Building Safety Codes

101 RancheHouse Rd.

Cochrane, AB T4C 2K8

Phone: 403-851-2572 Fax: 403-932-2935

Email: safety.codes@cochrane.ca



Fire Safety Plan

THIS PLAN MUST BE POSTED ONSITE AND OCCUPANTS/EMPLOYEES ARE EXPECTED TO BE TRAINED IN HOW TO FOLLOW ITS PROVISIONS

Address:

Description of Project: **Deck**

Contact Personnel:

Phone #:

Specific Considerations:

- Fire extinguisher(s) will be available at all times during the progress of the construction
- Access to fire hydrants and buildings for fire apparatus must be maintained

Emergency Response Numbers: FIRE/POLICE/AMBULANCE: 9-1-1

General Considerations:

- A WARNING SYSTEM will be in place to warn of potential threats, and facilitate evacuation (yelling, ringing of a bell or horn, etc.)
- EVACUATE via the nearest exit if you are warned of a fire
- PROCEED to the main entrance (outside) and report to the Fire Department
- FIGHT the fire ONLY if it is small and you are NOT ALONE

Hazards Control:

- At the end of each day combustible refuse will be cleared from the site area and disposed of in bins or stored in neat piles. Unused construction material will be kept neat and orderly.
- No open-flame devices will be used inside buildings unless a dedicated watch is in place
- Liquid Propane Tanks or flammable liquids containers are not allowed within buildings

This Fire Safety Plan is designed in conformance with and is a requirement of Division B, Section 2.8.2 of the National Fire Code, and on signature, becomes an agreement between the building owner/contractor and the Town of Cochrane Fire department.

I have read and understand the above

Building Owner/Contractor Name:

Date:

DECK DESIGN FORM

HOUSE

Site Plan:

Deck size: ft X ft = ft²

Deck height: ft

Distance to Property Lines:

 Rear: ft

 Left side: ft

 Right side: ft

 Front(if applicable): ft

Stairs: Y or No

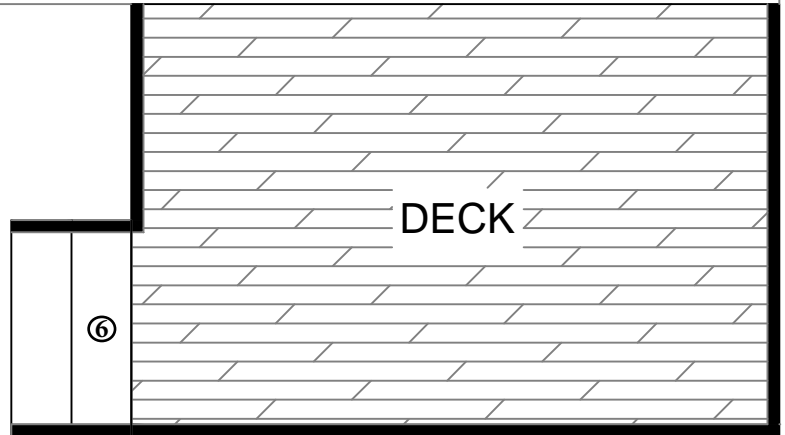

Construction Details:

① Joist size:(select one)

- 2X6 or
- 2X8 or
- 2X10 or
- 2X12

② Joist spacing:(select one)

- 12" on centre or
- 16" on centre or
- 24" on centre

③ Beam Size(min 3 PLY):(select one)

- 2X8 or
- 2X10 or
- 2X12

④ Post(min 6x6) spacing: ft

⑤ Foundation type:(select one)

- *Pile:
- Screw Pile([attach engineering](#)):

⑥ Stair(when applicable):

- Min step run: 255mm(10.2")
- Max step rise: 200mm(8")
- Min stair width: 860mm(34.4")

⑦ Hand/Guardrail

⑧ Joist Overhang:

- Max 18" for 2X6/2X8 Joists
- Max 24" for 2X10/2X12 Joists

Span Table (Span Book 2009, Canadian Wood Council)
spans based on S-P-F No.1&2

| JOIST SIZE | SPAN @ 12" O/C | SPAN @ 16" O/C | SPAN @ 24" O/C |
|------------|----------------|----------------|----------------|
| 2X6 | 10'-3" | 9'-4" | 8'-2" |
| 2X8 | 12'-4" | 11'-7" | 10'-9" |
| 2X10 | 14'-6" | 13'-8" | 12'-11" |
| 2X12 | 16'-7" | 15'-7" | 14'-8" |
| BEAM(3PLY) | POST SPACING | | |
| 2X8 | 10' | | |
| 2X10 | 12'-10" | | |
| 2X12 | 14'-11" | | |

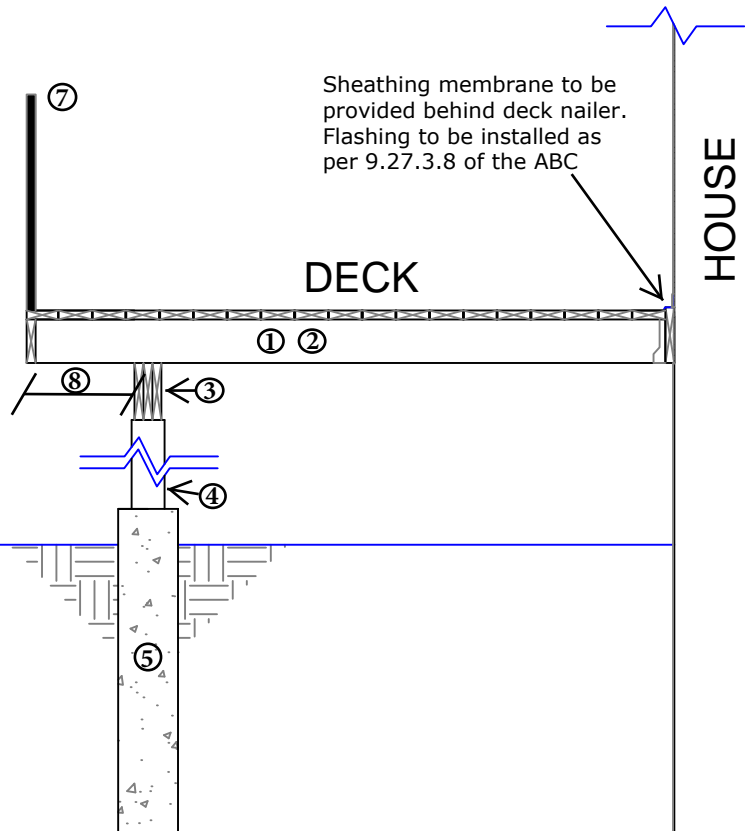

***Foundation Notes*:**

Concrete piles (min 9" in diameter) are to be installed not less than the depth of frost penetration and extend 150mm(6") above grade.

Town of Cochrane

Planning & Engineering Services

Safety Code Inspections

101 RancheHouse Road

Cochrane, AB T4C 2K8

Phone: 403-851-2572 Fax: 403-932-2935

Email: safety.codes@cochrane.ca



REQUIREMENTS FOR RESIDENTIAL DECKS

General Information

Building Permit Requirements

1. Building Permit Application Form to be completed by owner.
2. Fire Safety Plan Form to be completed by owner.
3. Deck Design Form to be completed by owner or builder.

GENERAL REQUIREMENTS:

REQUIRED GUARDRAILS:

On each side of Stair Tread or Deck Floor not protected by a wall that is equal to or greater than 600 mm (2') above adjacent ground level or the adjacent surface within 1.2m(4') of the deck floor has a slope more than 1 in 2.

GUARDRAIL HEIGHTS:

Deck height of 600 mm (2') to 1.8m(5.9'), 900 mm(36") high guards required.

Deck height over 1.8 m(5.9'), 1070 mm(3.5') high guards required.

DESIGN OF GUARDS

Openings in Guards shall not exceed 100 mm(4").

REQUIRED HANDRAILS:

Stairs containing 3 risers or more require a handrail on at least one side

HANDRAIL HEIGHT:

Handrails on stairs shall not be less than 865 mm(34.6") and not more than 965 mm(38.6") high.

DESIGN OF HANDRAIL:

A handrail shall have a clearance of not less than 50 mm(2") from any surface behind it. Handrails shall be constructed so as to be continually graspable along the entire length.

FOR ALL STAIR, RAMP, HANDRAIL AND GUARD REQUIREMENTS, PLEASE REFER TO SECTION 9.8 OF THE NATIONAL BUILDING CODE (2019) AB EDITION.