

TOWN OF COCHRANE

Building Safety Codes

101 RancheHouse Rd.
Cochrane, AB T4C 2K8
Phone: 403-851-2572 Fax: 403-932-2935
Email: safety.codes@cochrane.ca



Fields marked with an * are required

Homeowner Detached Garage Application

OWNER INFORMATION

Owner Name*	Phone*
Mailing Address*	Email*
City & Postal Code*	Additional Information if required: Sq.Ft *
Project Address*	
Garage Permit Fee Includes Building & Electrical	Estimated Construction Value*

APPLICANT DECLARATION I certify that I am the owner/agent submitting this application and construction will be completed in accordance with the Alberta Safety Codes Act and Regulations and will commence within **90 days**. I understand homeowner permits are to be completed within **365 days**.

I have read and understand the applicant declaration *

Applicant Name(Print)

Application Date(mm,dd,yyyy)

Please see our website for additional information regarding Garage specific installations related to the Building Code and Electrical Code.

The personal information collected through the permit application will be used to process your application. The information relates directly to and is necessary for the operation of the program or activity applied for and may be input into an automated system to generate content or make decisions, recommendations, or predictions. This information is collected and used under the authority of Section 4(c) of the Protection of Privacy Act and managed in accordance with the Act. For questions about the collection of personal information, please contact ATI@cochrane.ca.

The Alberta Safety Codes Act requires that a permit be obtained prior to beginning construction. Failure to obtain permits may result in the applicant being charged a double fee.

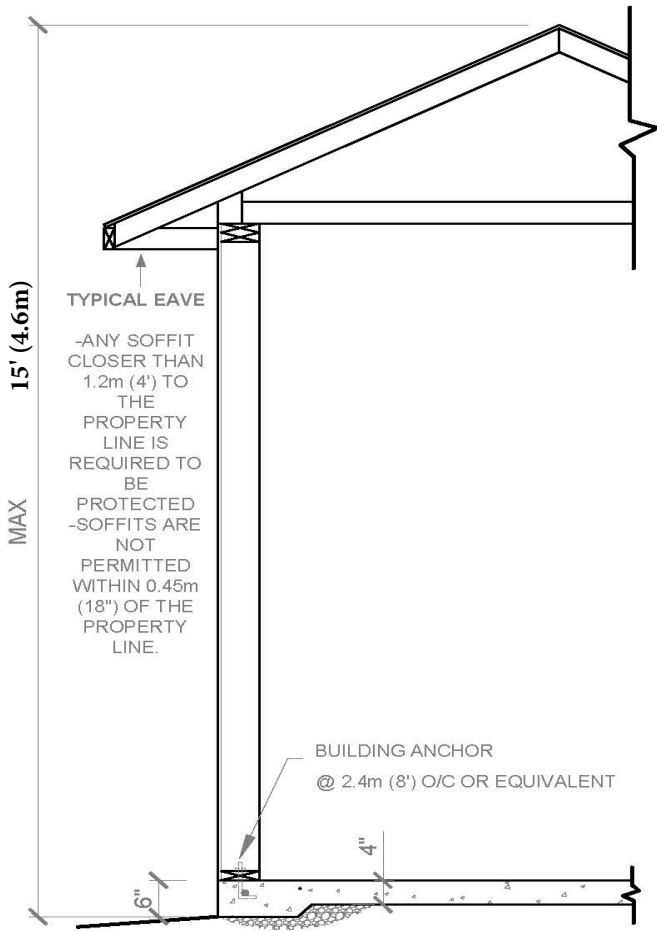

NOTE: ANY WOOD WITHIN 150mm (6") OF GRADE IS REQUIRED TO BE PROTECTED

ALTERNATE DETAILS
UP TO 55m² ACCESSORY BUILDINGS

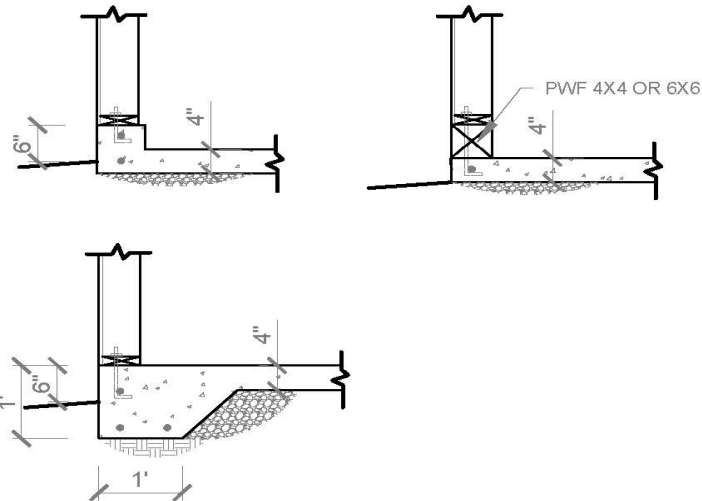

CONSTRUCTION DETAILS	
WALL FRAMING	ROOF FRAMING
2" x 4" @ 16" oc	Engineered Truss (1)
2" x 4" @ 24" oc	Stick-frame
2" x 6" @ 16" oc	I-Joist
2" x 6" @ 24" oc	Structural Ins. Panel
Insulated	ROOF SHEATHING
Other	3/8" OSB/Plywood
WALL SHEATHING	1/2" OSB/Plywood
3/8" OSB/Plywood	Other
1/2" OSB/Plywood	ROOFING MATERIAL
Other	Asphalt
EXTERIOR WALL FINISH	Wood Shakes/Shingles
Vinyl	Other
Stucco	Heat (Insulation/Vapour Barrier Required) IF APPLICABLE
Metal	Gas
Hardie Board	Electric

SETBACKS & MAX HEIGHT

Distance to rear property line at least 4'(1.2m):	Yes	No
Distance to side property line at least 2'(0.6m):	Yes	No
corner lots require at least 10'(3m) from street side property line		
Height will be 15' or less (4.6m):	Yes	No

NOTES

Concrete strength for garage slab is to be not less than 32 MPa.

Beam (header) above overhead door

2 ply 2" x 10" for maximum 9' 6" opening

4 ply 2" x 12" for maximum 16' 6" opening

Engineered beam – Submit engineered specifications

(1) Engineer stamped truss profiles are to be submitted with the application

CONSIDERATIONS

Check to ensure the garage meets the setbacks of the [Land Use Bylaw](#).

Permanent structures may *not* be built on easements or right of ways.

Call before you dig - [Alberta One Call](#)

TOWN OF COCHRANE

Building Safety Codes

101 RancheHouse Rd.

Cochrane, AB T4C 2K8

Phone: 403-851-2572 Fax: 403-932-2935

Email: safety.codes@cochrane.ca



Fire Safety Plan

THIS PLAN MUST BE POSTED ONSITE AND OCCUPANTS/EMPLOYEES ARE EXPECTED TO BE TRAINED IN HOW TO FOLLOW ITS PROVISIONS

Address:

Description of Project: **Detached Garage**

Contact Personnel:

Phone #:

Specific Considerations:

- Fire extinguisher(s) will be available at all times during the progress of the construction
- Access to fire hydrants and buildings for fire apparatus must be maintained

Emergency Response Numbers: FIRE/POLICE/AMBULANCE: 9-1-1

General Considerations:

- A WARNING SYSTEM will be in place to warn of potential threats, and facilitate evacuation (yelling, ringing of a bell or horn, etc.)
- EVACUATE via the nearest exit if you are warned of a fire
- PROCEED to the main entrance (outside) and report to the Fire Department
- FIGHT the fire ONLY if it is small and you are NOT ALONE

Hazards Control:

- At the end of each day combustible refuse will be cleared from the site area and disposed of in bins or stored in neat piles. Unused construction material will be kept neat and orderly.
- No open-flame devices will be used inside buildings unless a dedicated watch is in place
- Liquid Propane Tanks or flammable liquids containers are not allowed within buildings

This Fire Safety Plan is designed in conformance with and is a requirement of Division B, Section 2.8.2 of the National Fire Code, and on signature, becomes an agreement between the building owner/contractor and the Town of Cochrane Fire department.

I have read and understand the above

Building Owner/Contractor Name:

Date: